

The Robinson Suite

Upper Ground Floor

Suite 1 & 2 Capacity

Theatre	130
Banquet 10/12	80/96
Classroom	75
Cabaret	56
Exhibition	110

Suite 1 Capacity

Theatre	65
Classroom	36
Cabaret	24
Exhibition	55
Banquet 10/12	40/48

Suite 2 Capacity

Theatre	65
Classroom	36
Cabaret	24
Exhibition	55
Banquet 10/12	40/48

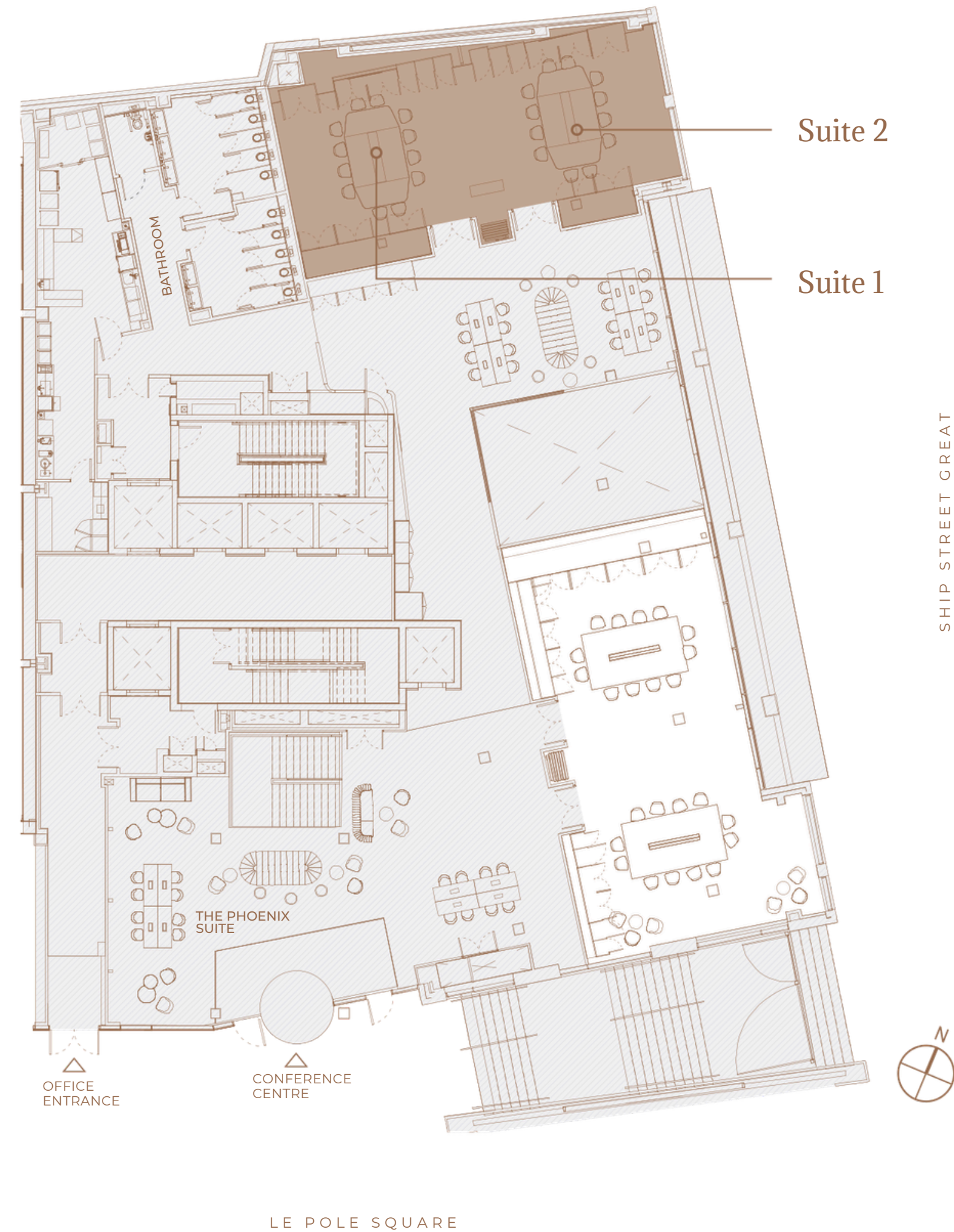

The Robinson Suite is named after Ireland's first female President & former United Nations High Commissioner for Human Rights. This space offers flexible event set ups and also overlooks Ship Street & Dublin Castle.

Location: Upper ground floor

Size: 108 sq. m

Ceiling height: 3.2 m

Dividable: Yes

Natural daylight: Yes

Screens & projectors: In-built

Air-conditioning: Yes

Free Wi-Fi: Yes

Pillars: No

Lobby: 277 sq. m / Breakout area

