

# The Douglas Hyde Suite

## Lower Ground Floor

### Suite 1 & 2 Capacity

Theatre	800
Banquet	550
Classroom	400
Cabaret	384
Exhibition	1000

### Suite 1 Capacity

Theatre	400
Banquet	270
Classroom	200
Cabaret	192
Exhibition	500

### Suite 2 Capacity

Theatre	400
Banquet	270
Classroom	200
Cabaret	192
Exhibition	500

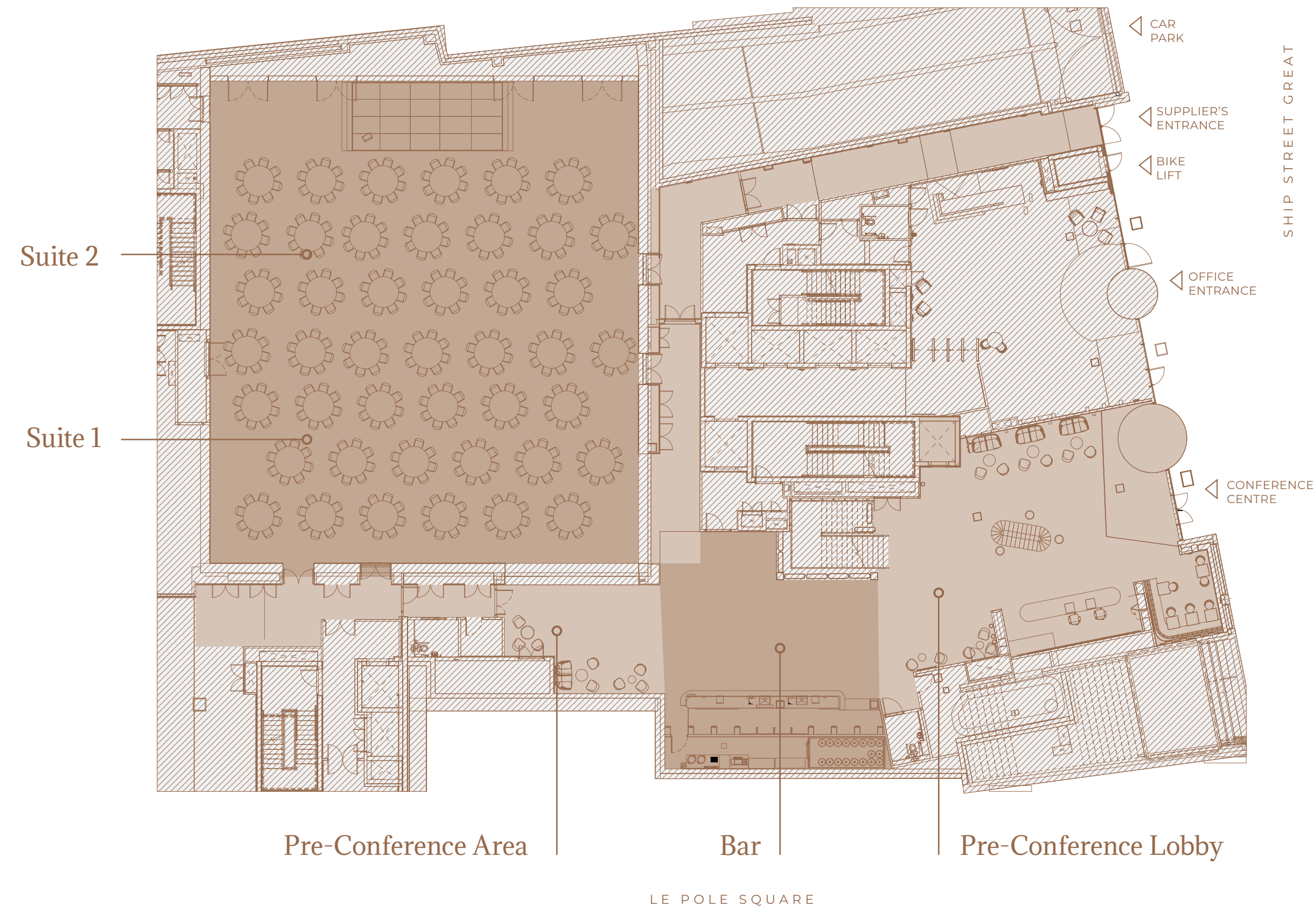

Named after Ireland's first President, The Douglas Hyde Suite can be divided into two suites and has been purposefully designed with large scale conferences, exhibitions & events in mind.

Location: Lower ground floor

Size: 704 sq.m

Ceiling height: 7.7m

Dividable: Yes

Natural Daylight: No

Screens & projectors: In-built

Air-conditioning: Yes

Free Wi-Fi: Yes

Pillars: No

Lobby: 391 sq. m preconference

